

## TWR-W

**TEE REDUCER**

Without shoulder

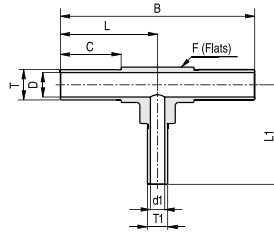

Ordering Information	L		L1		B		C		d		d1		F	T Tube O.D.	W.T. (T)	T1 Tube O.D.	W.T. (T1)
	mm	inch	mm	inch	mm	inch	mm	inch	mm	inch	mm	inch	inch	inch/mm	inch/mm	inch/mm	inch/mm
P-TWR-3/8X1/4 W	30.5	1.20	31.2	1.23	61.0	2.40	19.1	0.75	7.7	0.30	4.6	0.18	7/16	3/8"	0.035"	1/4"	0.035"
P-TWR-1/2X1/4 W	34.0	1.34	34.0	1.34	68.0	2.68	19.1	0.75	10.2	0.40	4.6	0.18	11/16	1/2"	0.049"	1/4"	0.035"
P-TWR-1/2X3/8 W	34.0	1.34	34.0	1.34	68.0	2.68	19.1	0.75	10.2	0.40	7.7	0.30	11/16	1/2"	0.049"	3/8"	0.035"
P-TWR-3/4X1/4 W W.T.= 0.049 X 0.035	37.1	1.46	37.1	1.46	74.2	2.92	19.1	0.75	16.6	0.65	4.6	0.18	15/16	3/4"	0.049"	1/4"	0.035"
P-TWR-3/4X1/4 W W.T.=0.065 X 0.035	37.1	1.46	37.1	1.46	74.2	2.92	19.1	0.75	15.8	0.62	4.6	0.18	15/16	3/4"	0.065"	1/4"	0.035"
P-TWR-3/4X1/2 W W.T.=0.049	37.1	1.46	37.1	1.46	74.2	2.92	19.1	0.75	16.6	0.65	10.2	0.40	15/16	3/4"	0.049"	1/2"	0.049"
P-TWR-12MMX6MM W	34.0	1.34	34.0	1.34	68.0	2.68	19.1	0.75	10.0	0.39	4.0	0.16	11/16	12mm	1.00mm	6mm	1.00mm

## CW-W

**CROSS**

Without shoulder

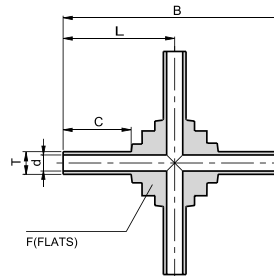

Ordering Information	L		B		C		d		F	T Tube O.D.	W.T.	
	mm	inch	mm	inch	mm	inch	mm	inch	inch/mm	inch/mm	mm	inch
P-CW-1/4-W	31.2	1.23	62.5	2.46	19.1	0.75	4.6	0.18	17mm	1/4"	-	0.035
P-CW-3/8-W	30.5	1.20	61.0	2.40	19.1	0.75	7.7	0.30	17mm	3/8"	-	0.035
P-CW-1/2-W	31.0	1.22	62.0	2.44	19.1	0.75	10.2	0.40	17mm	1/2"	-	0.049
P-CW-1/2-W W.T.=0.065	31.0	1.22	62.0	2.44	19.1	0.75	9.5	0.37	17mm	1/2"	-	0.065
P-CW-6MM-W	31.2	1.23	62.5	2.46	19.1	0.75	4.0	0.16	17mm	6mm	1.00	-
P-CW-8MM-W	30.5	1.20	61.0	2.40	19.1	0.75	6.0	0.24	17mm	8mm	1.00	-
P-CW-10MM-W	31.0	1.22	62.0	2.44	19.1	0.75	8.0	0.31	17mm	10mm	1.00	-
P-CW-12MM-W	31.0	1.22	62.0	2.44	19.1	0.75	10.0	0.39	17mm	12mm	1.00	-

Dimensions are for reference only, and are subject to change without notice.  
When ordering, be sure to add the Surface-Finish Designator (either H or E) to the Part Number. (See Material Table, page 157).